

**RC2 Multi-Camera Application Note 003: Camera connectivity line drawing**

This application note describes the simple integration of multiple high definition or other high quality Pan Tilt Zoom cameras using SCT's RemoteCam2 Cat5e kits. This camera installation kit uses only two Cat5e UTP cables up to 300' long. These two cables provide camera power, component Y/Pb/Pr video, remote control, control loop and control IR. UTP cable compensation is accomplished within the RemoteCam2 hardware with the push of a button to automatically compensate for video gain, EQ and skew so the video image appears as if no cable extensions were used!



**Sony EVI-HD1**

Shown on RC2-HDS mount

**Typical cameras:**

- EVIHD1
- BRC300
- BRCH700
- BRCZ700

Optional camera wall mounts and RC2-RK1 4-device equipment shelf complete the clean professional integration.

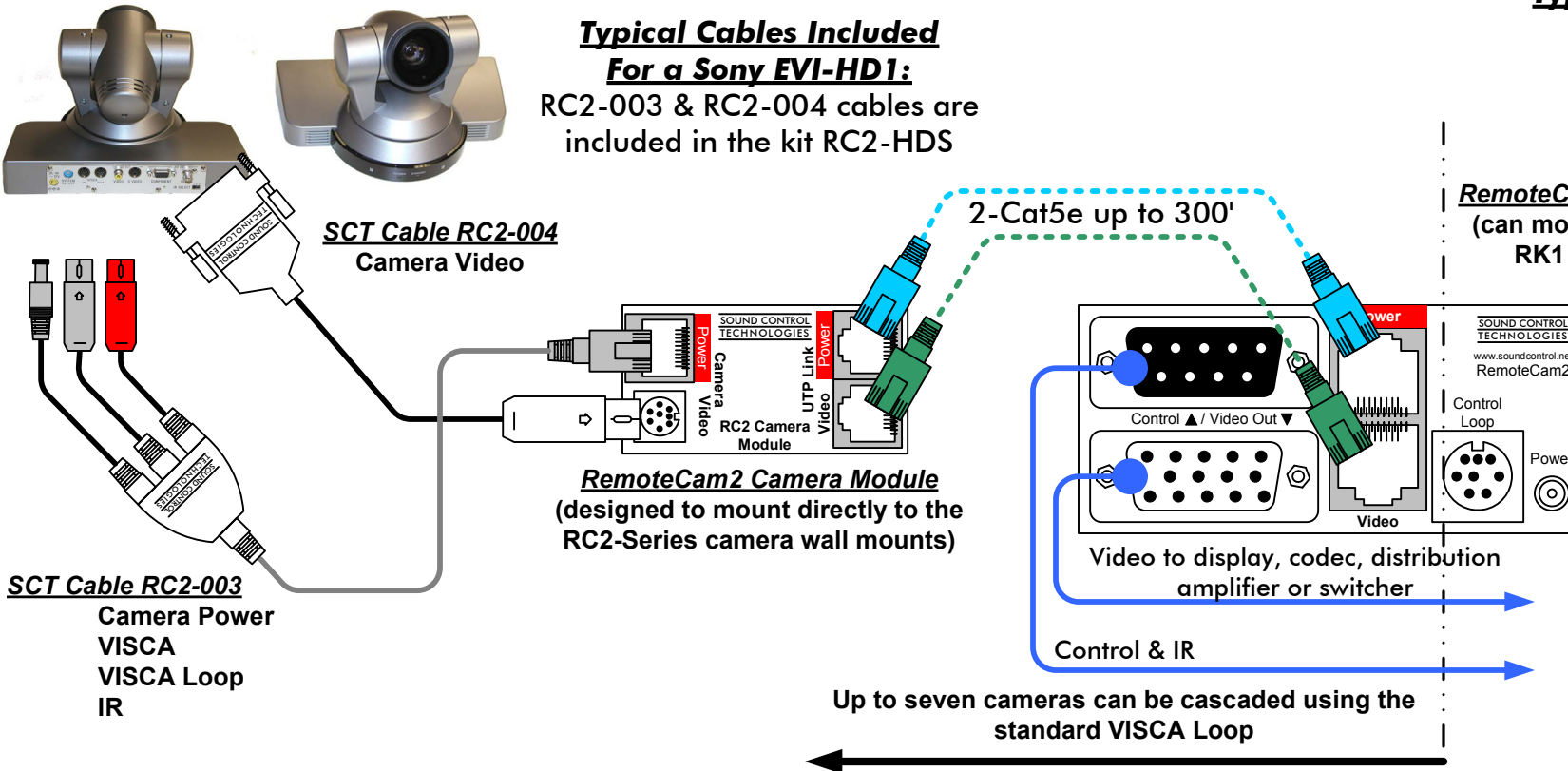

**Note:** The only time the Red 8-Pin mini DIN connector on the RC2-003 cable would be used is to connect the VISCA Out jack for the VISCA Loop function. This control loop is applicable when there is a "next" camera in the VISCA control loop.

**SOUND CONTROL TECHNOLOGIES**

28 Knight Street  
 Norwalk, CT., USA 06851  
 Phone (203) 854-5701  
 Fax (203) 854-5702

RemoteCam2 Typical Application  
 Multi Camera Installation

© SOUND CONTROL TECHNOLOGIES, INC. 2009

Drawn by:	/SCT	Drawing Date:	03/23/2009
Checked by:	/SCT		
		Page:	1 of 3
		Rev:	-

**RC2 Multi-Camera Application Note 003: VISCA Loop Functionality**

Unique to the RemoteCam2 wiring configuration; all VISCA Loop wiring is accomplished in the rack with a simple RC2-104 cable connecting the main camera's 8-Pin mini DIN "Control Loop" port to the DB-9 "Control" port on the next camera's head end module. This process can be repeated up to seven times to fully utilize the VISCA Loop. This control loop is used with joystick controllers and other remote control devices.



**Sony EVI-HD1**

Shown on RC2-HDS mount

RemoteCam2 Head End 1

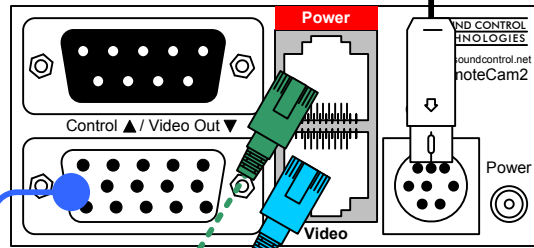

Video to display, codec, distribution amplifier or switcher

RC2-104 Control Loop Cable (optional cable)

RemoteCam2 Head End 2

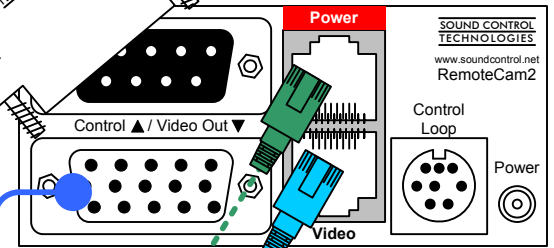

Video to display, codec, distribution amplifier or switcher

Camera 1 Module

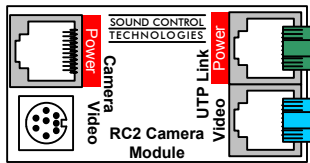

2-Cat5e up to 300'  
Camera 1 Wiring

Camera 2 Module

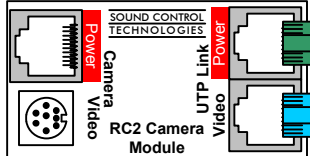

2-Cat5e up to 300'  
Camera 2 Wiring

**RC2 Multi-Camera Application Note 003**

Simple line drawings of a 4-camera RemoteCam2 multi-camera configuration with VISCA Loop using SCT RC2-104 cables to connect between "Control Loop" ports and "Control" ports on the RemoteCam2 Head End modules. Note that all cabling is configured to concentrate at the equipment rack so wiring is not required between cameras in the working environment.



**Sony EVI-HD1**  
Shown on RC2-HDS mount

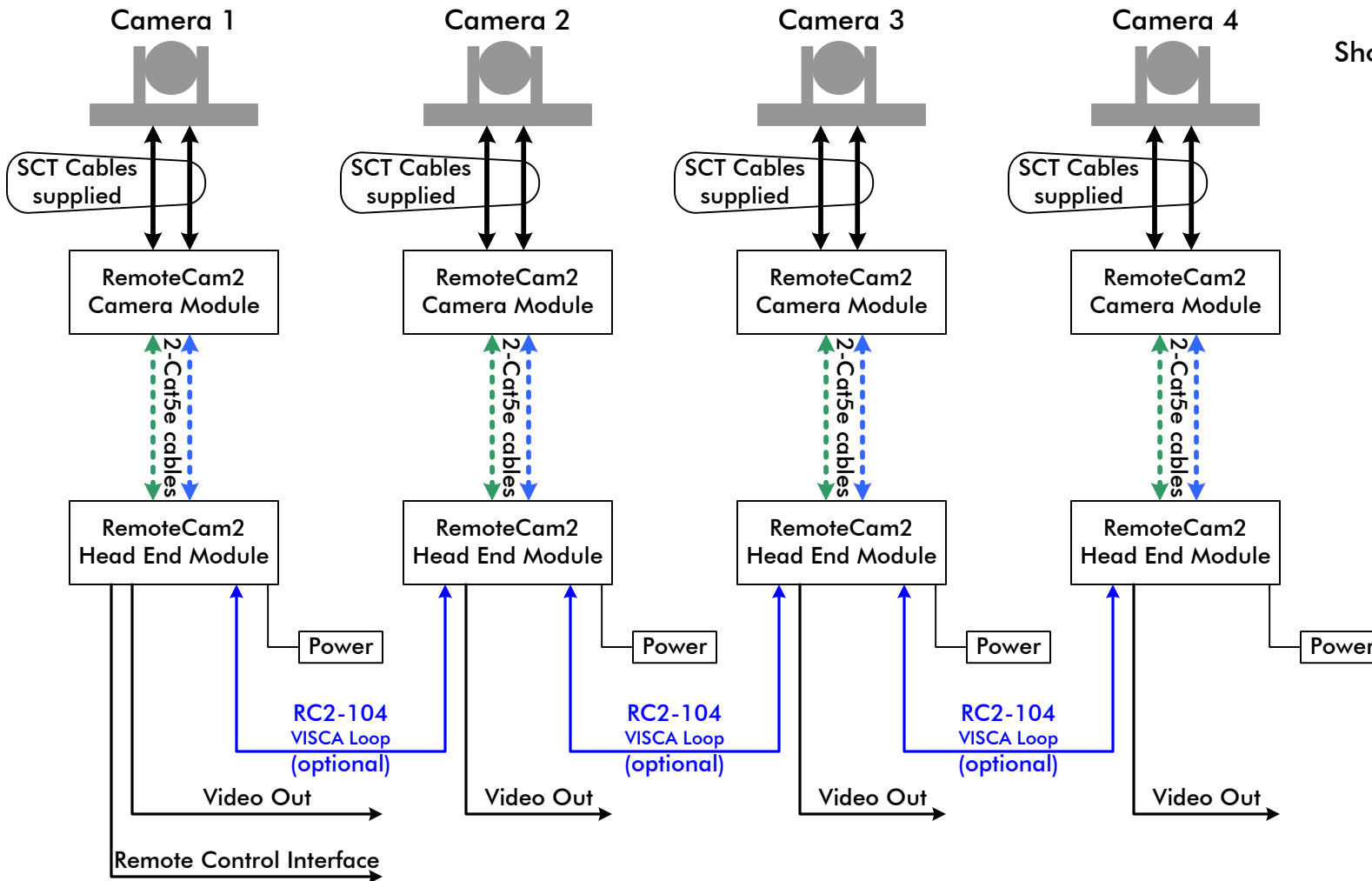

**Typical cameras:**

- EVIHD1
- BRC300
- BRCH700
- BRCZ700